

SCALE: 1" = 30'

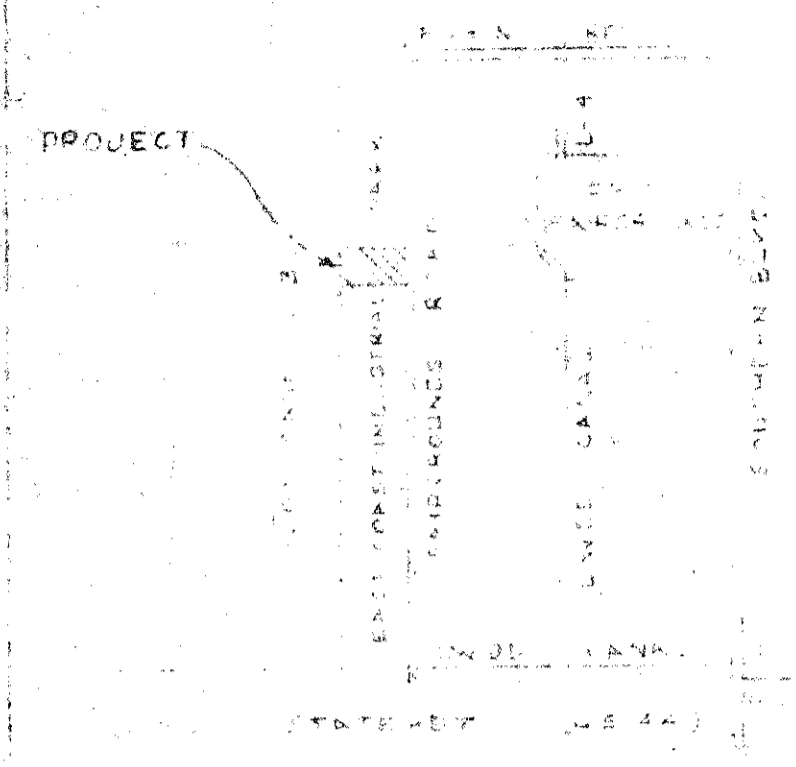
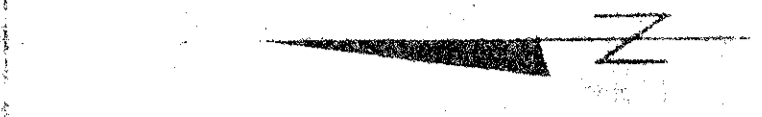

LOCATION MAP  
SCALE

GENERAL NOTES

1. NO EXISTING STRUCTURES ON SITE NOR WITHIN 100 FEET OF OUTSIDE BOUNDARIES.
2. ENTIRE SITE TO BE FENCED WITH 6' HIGH CHAIN LINK FENCE WITH SINGLE STRAND SECURITY CAP AND TWO 36" WIDE DOUBLE SWING GATES (ONE AT EACH DRIVE)
3. NO OUTDOOR LIGHTING IS PROPOSED.
4. SITE IS FILLED TO ELEVATION 16.5 (MSL) WITH MEDIUM GRAIN SANDY MATERIAL (CLASSIFICATION A-3)

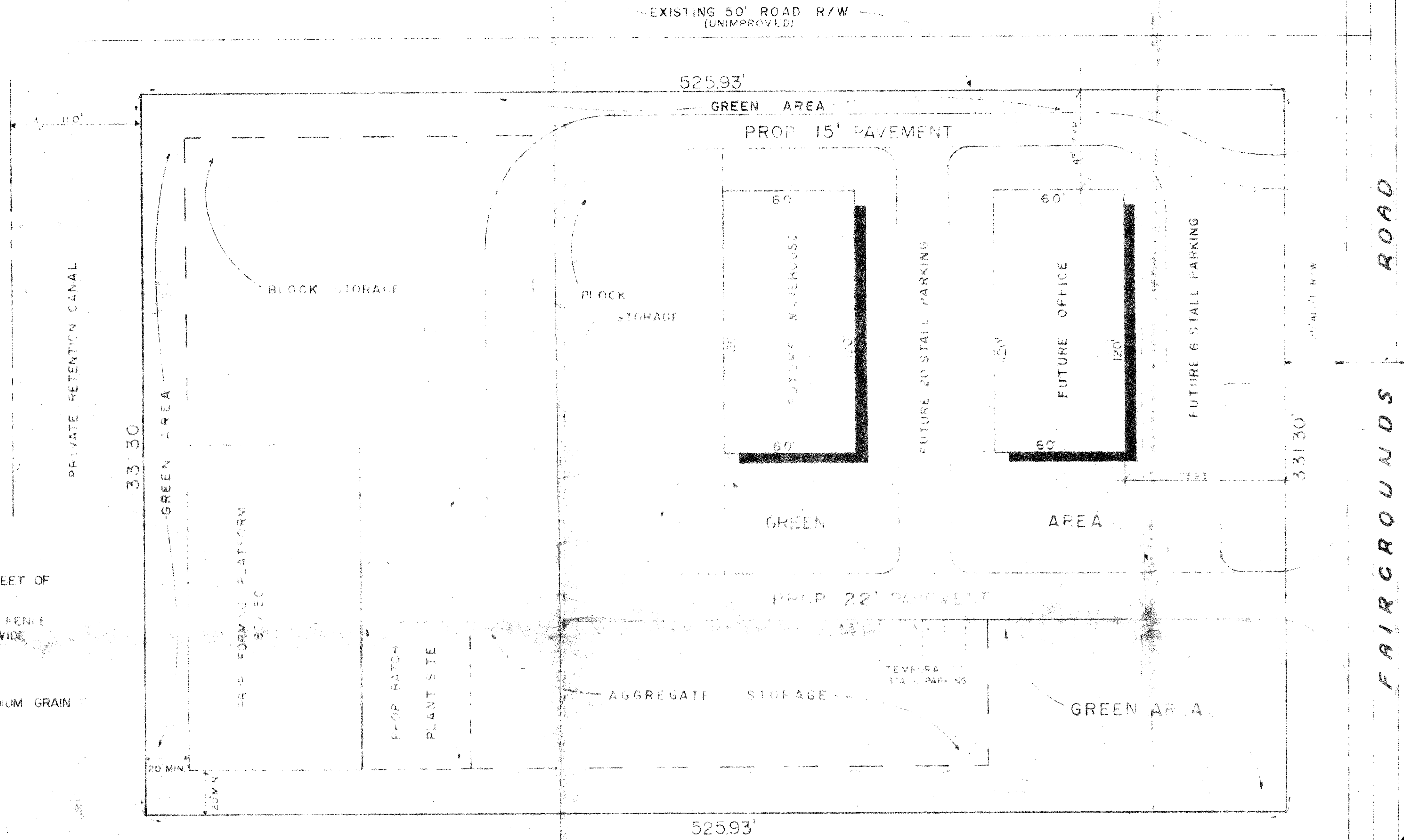

STATISTICAL PRESENTATION

TOTAL SITE AREA	174,240 S.F. (4 ACRES <sup>2</sup> )	100 %
BUILDING AREA	14,400 S.F.	8 %
FORMING PLATFORM AREA	12,000 S.F.	7 %
ROAD & PARKING AREA	3,191.5 S.F.	1.8 %
OPEN STORAGE AREA	51,275 S.F.	30 %
BATCH MACHINE AREA	3,750 S.F.	2 %
GREEN AREA	60,900 S.F.	35 %

11  
REVISIONS  
PART 1100  
#79-141

ur0289.igr  
EAST COAST INDUSTRIAL PARK PG1

**SITE PLAN**

**TERRAFIX PRODUCTION FACILITY**

EAST COAST INDUSTRIAL PARK  
PALM BEACH COUNTY, FLA.

**STERN ARCHITECTS: PLANNERS INC.**  
1000 W. ASHEVILLE NORTH CAROLINA  
SERIAL HIGHWAY SUITE 128 BOCA RATON FLORIDA  
CONSULTANT

**SOUTH**  
66 BOC  
3200 N  
PROJECT

SHEET 1

OF SHEETS

135  
DRAWN BY J.P.P.  
CHECKED BY T.L.F.P.  
DESIGNED BY T.L.F.P.  
APPROVED BY R.W.S.

DATE 5-25-79

JUL 19 1979